

CONTACT US

If you have any queries please email clare.rankin@cambridge.gov.uk or call 01223 457108. You can also contact one of your ward Councillors who are supporting the scheme.

YOUR VIEWS

Please let us know what you think about the proposed changes in layout to the roundabout and return this form by **19th March 2012** using the freepost address below or alternatively fill out the questionnaire online at www.cambridge.gov.uk/consultations

1. Do you support the proposed changes to the layout of the Radegund Road/Perne Road roundabout in order to improve the safety of cyclists and pedestrians?

YES NO

2. How do you usually travel in this area? (Please circle all that apply to you)

Walk / Cycle / Public Transport / Car / Other:

Comments

3. Please indicate which street you live on:



February 2012



SAFETY IMPROVEMENTS TO RADEGUND ROAD/ PERNE ROAD/ BIRDWOOD ROAD ROUNDABOUT

We Are keen to hear your views on proposed changes to the roundabout in order to improve safety for cyclists and pedestrians.

What is the problem?

The current layout of this roundabout allows vehicles to use the fastest and most direct line through the roundabout, which means that speeds are high and it is extremely hostile for cyclists and pedestrians. This roundabout is a known accident site for cyclists.

There are also currently no crossing facilities for pedestrians near the roundabout on Birdwood Road or Radegund Road, both of which have secondary schools located on them.

What is proposed?

The new layout (see overleaf) significantly reduces the space for traffic around the roundabout and tightens both the exits and entries into the roundabout. The design follows guidance from the Department for Transport on making roundabouts more cycle-friendly.

The change in geometry will ensure that drivers keep their speeds low to negotiate the tighter turns with an overrun area provided for larger vehicles. This will improve safety for all, particularly for on-road cyclists.

The layout provides significant improvements for pedestrians with wide, direct crossings on the Birdwood Road and Radegund Road arms of the roundabout where currently no crossing facilities exist. It will also present an opportunity to improve the appearance of the area with additional trees and grass verges.

Funding

The scheme will benefit from European funding through the 2 Seas Bike Friendly Cities Project with additional funding from the Cambridge City Council and Cambridgeshire County Council jointly funded cycleways budget.

What happens next?

Below is an indicative timeline of key events:

- Public consultation Ends 19th March 2012
- City Council officers available for information at the East Area Committee 9th February 2012
- Public Exhibition (Coleridge School) 27th/28th February 6-8pm
- Scheme considered by City Council Environment Scrutiny Committee June 2012
- Consultation results considered by Cambridge Traffic Management Area Joint Committee July 2012
- Construction work starts on site if approved Autumn/Winter 2012

BUSINESS REPLY SERVICE
Licence No. ANG6390

2

**STREETS AND OPEN SPACES
PROJECT DELIVERY
CAMBRIDGE CITY COUNCIL
PO BOX 700
CAMBRIDGE
FREEPOST ANG 6390
CB1 0JH**

"This map is reproduced from Ordnance Survey material with the permission of Ordnance Survey on behalf of the Controller of her Majesty's Stationary Office © Crown copyright. Unauthorised reproduction infringes Crown copyright and may lead to prosecutions or civil proceedings." Cambridge City Council (Licence no. 100019730) 2011.

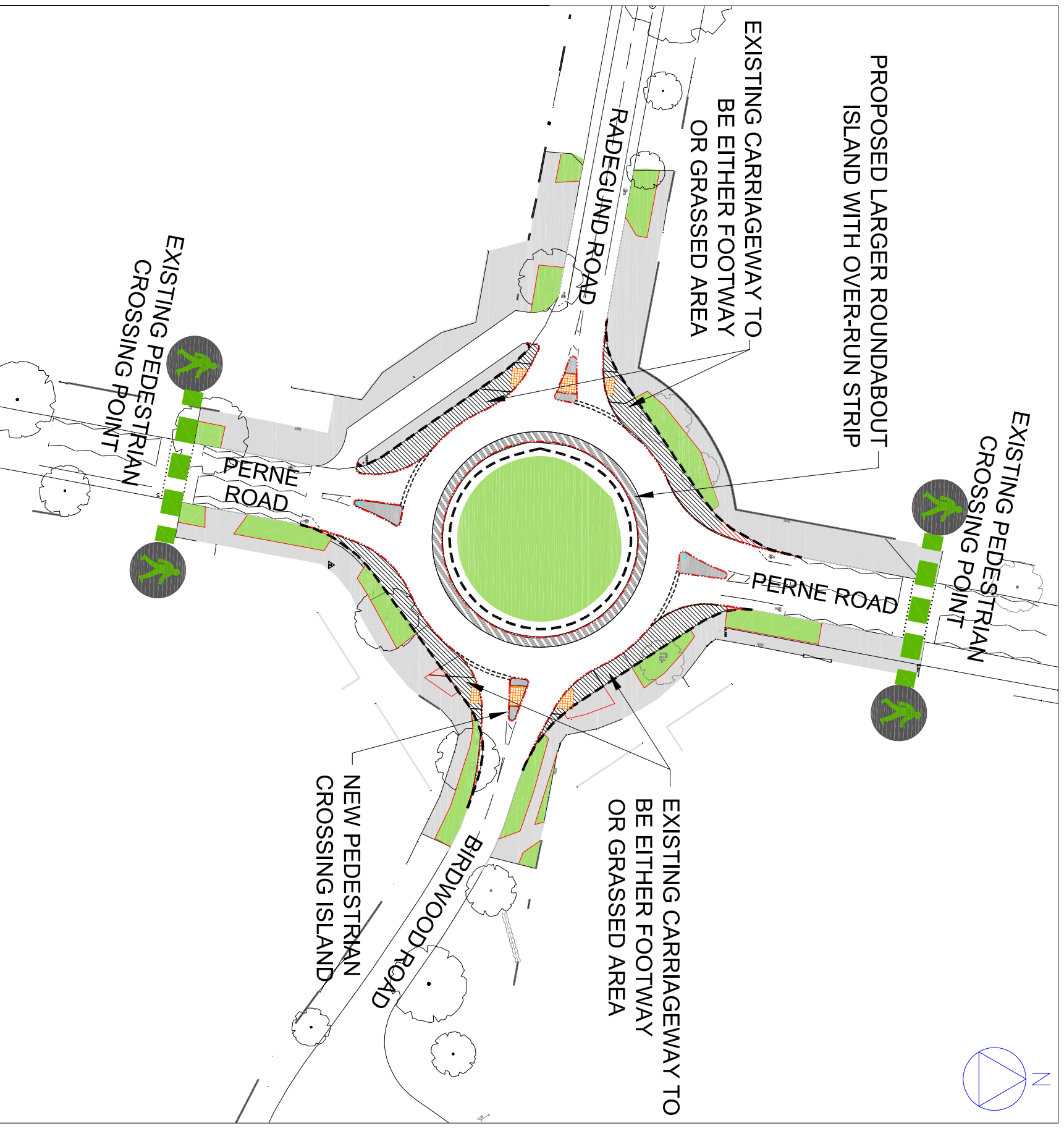
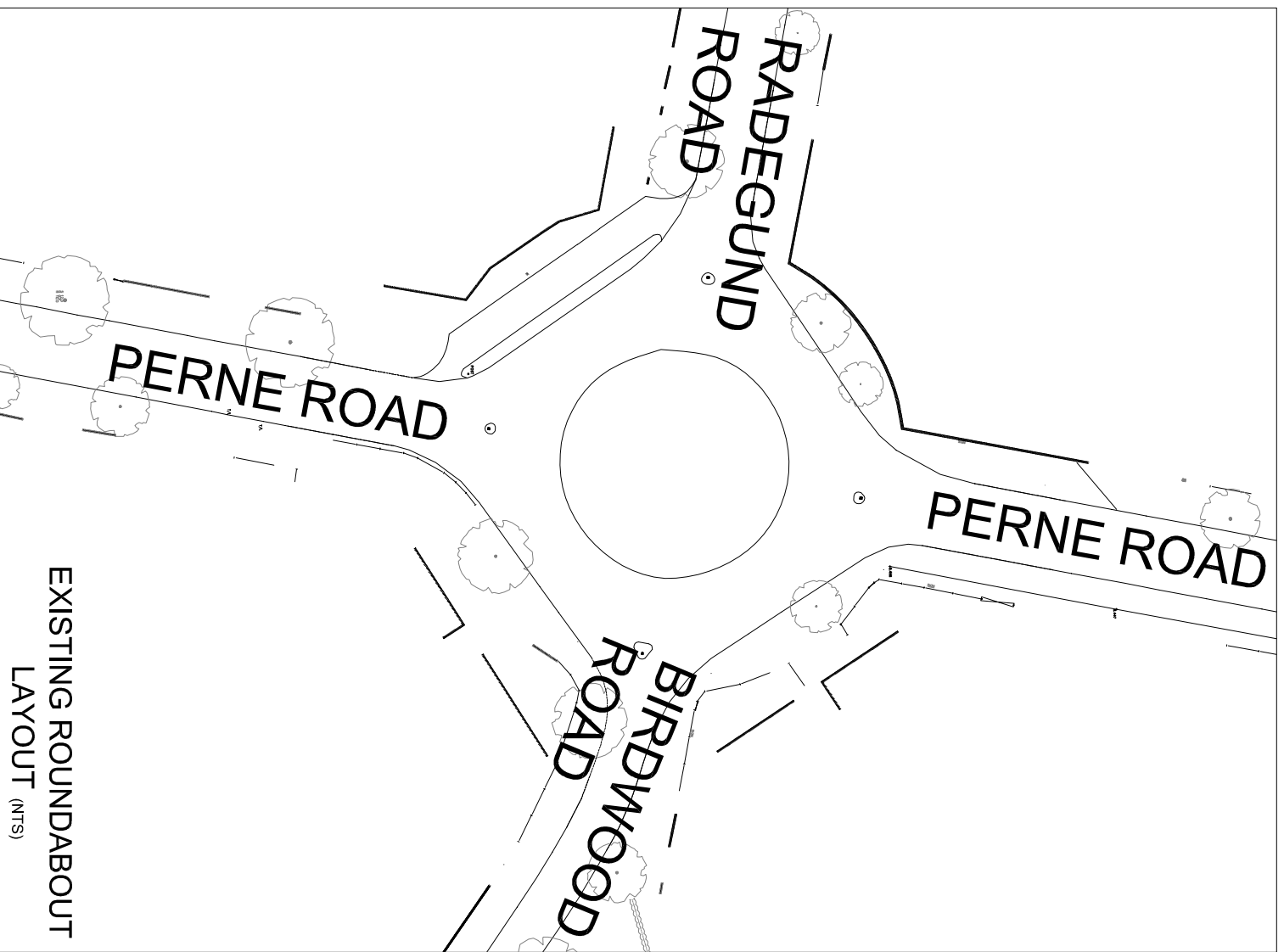
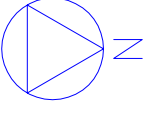

Cambridgeshire
County Council



CAMBRIDGE
CITY COUNCIL



**ENVIRONMENT DEPARTMENT
STREETS & OPEN SPACES**

Simon Payne
Director of Environment
CAMBRIDGE CITY COUNCIL
PO BOX 700, Cambridge, CB1 0JH
Tel: 01223 - 457200 or 457201

Scale:	By:	Date
Not to Scale	NB	18.01.2012
Rev / Date	By	Chk
		App
		Details

DO NOT SCALE
Figured dimensions must be taken in preference to scaled dimensions.

Project: **PERNE RD ROUNDABOUT**

Drawing: **PROPOSED ALTERATIONS**

Job Ref /
DWG.No

CD-01

Revision

-